

Under-mount Sink Installation Instructions

For Models 561-0584, 561-0585, 561-0409, 561-0546,
561-8826, 562-0195, 562-5796 & 562-6291

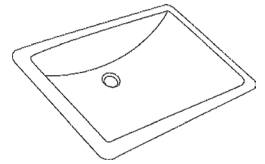

CAUTION: PRODUCT IS FRAGILE. TO AVOID BREAKAGE AND POSSIBLE INJURY HANDLE WITH CARE!

1 NOTE: To avoid damage to countertop, install sink such that future removal from underneath the countertop is possible.

First, make sure the clearance between the backsplash, faucet, fixtures and cabinets are acceptable for the new sink.

For this sink to be ADA compliant the sink must be installed with the overflow in the rear.

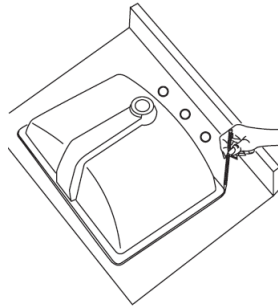

2 Carefully cut out the enclosed template, then position and trace the template on the countertop as shown on the template. Mark the faucet hole centerline on the countertop. Drill a 1/2" pilot hole on the inside of the cut line. Use a saber saw to cut out the countertop opening.

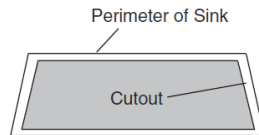

3 FOR WOOD COUNTERTOP

Mark and pre-drill the wood screw holes as located on the enclosed template. Waterproof any exposed areas of wood.

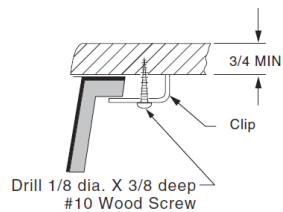

4 FOR MARBLE OR SOLID SURFACE COUNTERTOP

To protect countertop, place it on foam padding and drill 3/8" diameter x 1/2" deep hole as per location shown on template.

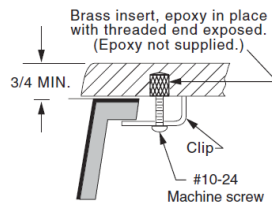

5 Mount the drain assembly (not included) on the sink, following faucet manufacturer's instructions. Be certain to apply a bead of sealant on the underside of the drain (A) in order to ensure a watertight seal between the sink and drain. Remove excess sealant after installing drain on sink.

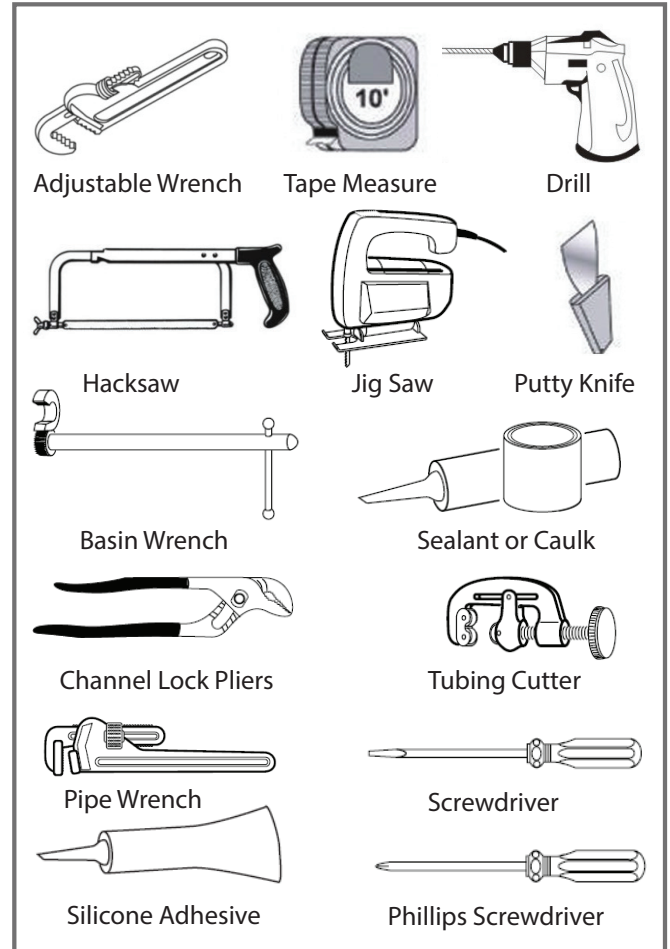
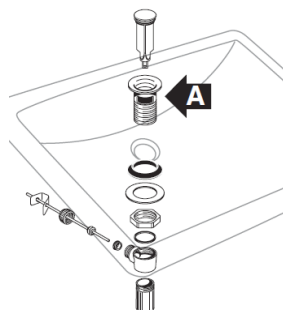

6 NOTE: Do not use adhesives or adhesive sealants until you have checked the fit and alignment of sink to cut out. After checking the fit and alignment of sink, apply a bead of silicone adhesive to rim of sink.

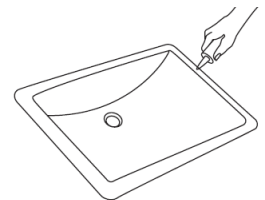

7 Center bowl over cutout and tighten screws. (see 3 or 4) to secure sink to countertop. Remove excess sealant from inside lip.

NOTE: The screws provided should be used on countertops with a minimum 1" thickness. For thinner countertops, use appropriate anchors and fasteners.

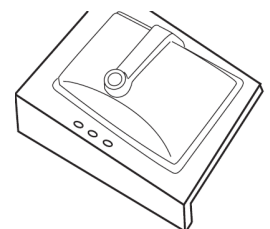

Under-mount Sink Installation Instructions

For Models 561-0584, 561-0585, 561-0409, 561-0546,
561-8826, 562-0195, 562-5796 & 562-6291

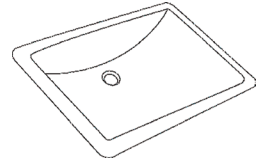

CAUTION: PRODUCT IS FRAGILE. TO AVOID BREAKAGE AND POSSIBLE INJURY HANDLE WITH CARE!

8 Install faucet (not included) and countertop (not included) following manufacturer's instructions.

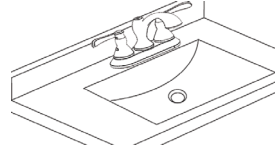

9 Connect supply line to faucet (finger tight) and carefully bend tubes to engage with the supply shut-off valves. Tighten connections at faucet and shut-off valves for a water tight seal.

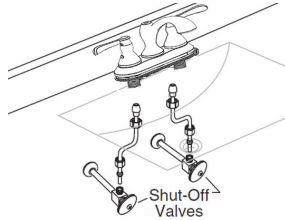

10 Connect trap to drain assembly hand tight to check alignment. It may be necessary to cut off part of the tailpiece (B) or the part of the horizontal leg of the trap (C). Secure joints for watertight assembly.

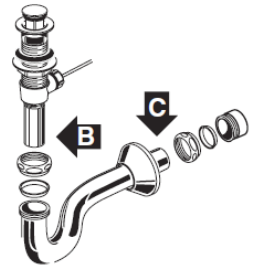

LIMITED WARRANTY

Vitreous China

Compass Manufacturing International Vitreous China is warranted to the original consumer purchaser to be free from defects in material and workmanship for as long as the original consumer purchaser owns the home in which the sink was first installed or for 5 years from the date of purchase.

Compass Manufacturing International will replace, free of charge, during the applicable warranty period, any part or finish that proves defective in material and/or workmanship under normal installation, use and service. Compass Manufacturing International recommends using a professional plumber for all installation and repair. Replacement parts may be obtained by emailing the address below, calling the number below or by writing to:

Compass Manufacturing International
6702 Enterprise Drive
Louisville, KY 40214
800.626.3525
warranty@cmiproduct.com

Vitreous China Product Care

Rinse thoroughly and use a soft cloth to wipe the product dry after each use.

Regular Maintenance:

Remove stains using a cleaning product that contains mild abrasives; rinse and towel dry. Strong abrasive cleaners will scratch and dull the surface.

Products to Consider

Comet Bathroom Cleanser
Formula 409 Antibacterial All Purpose

Windex Original
Soft Scrub Original